

# Enova

Design, calculations and manufacturing  
of Storage Systems

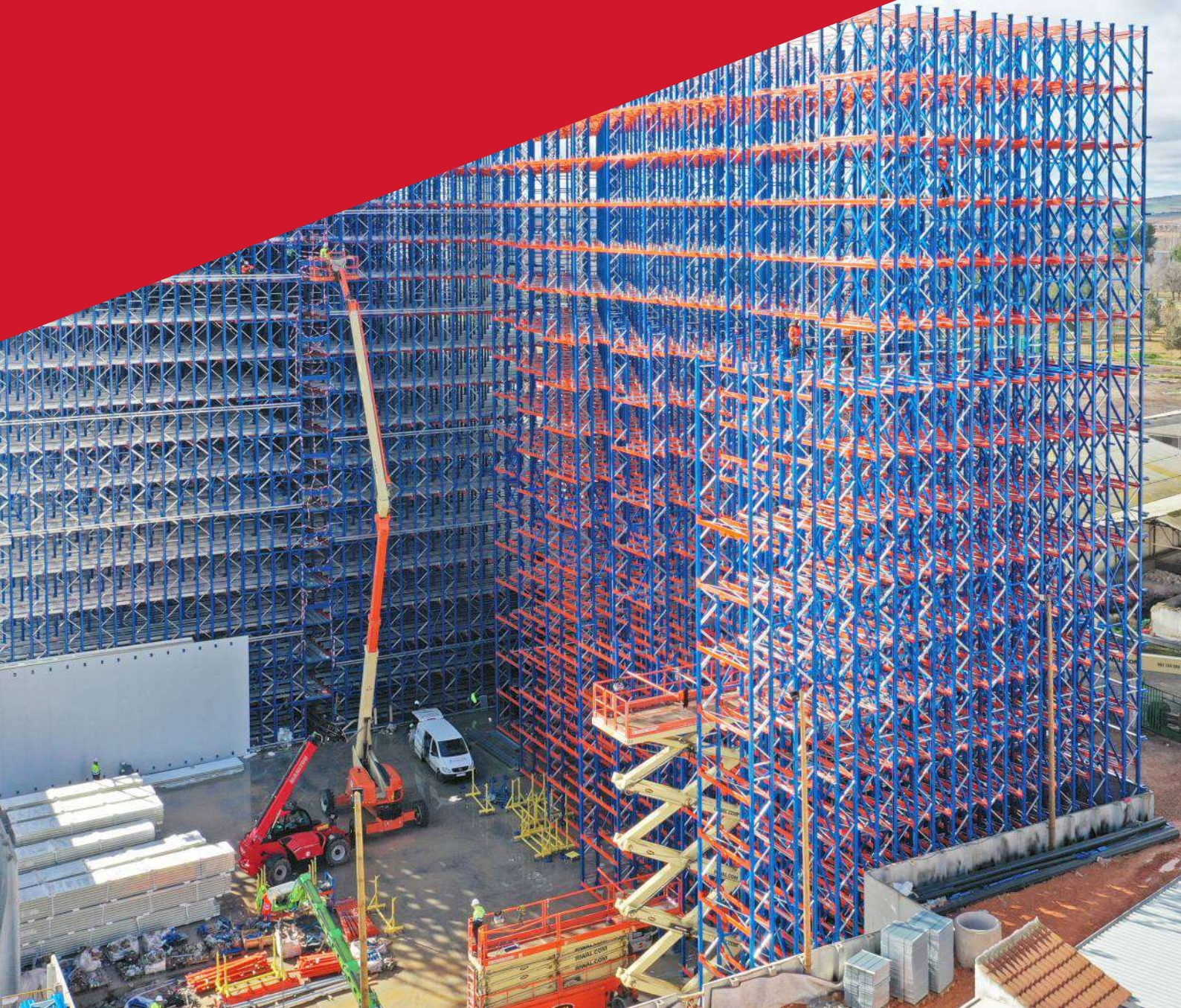

**RACK CLAD BUILDINGS & AUTOMATED STORAGE SYSTEMS**

The **Strength** of simplicity



We have a background of more than **50 years of knowledge** in the design and manufacturing of Storage Systems. We have consolidated and strengthened our position based on the humility and freshness of a young and specialized team, which added to our latest generation technologies, makes **ESNOVA** enjoy the trust and confidence of our worldwide customers.



WE EXPORT TO OVER THAN **30 COUNTRIES**



## EXPERIENCE

We have a large group of professionals with a long career in the logistics sector.

Design, calculations and manufacturing of **Storage Systems**

We can give you an efficient and direct response. We count with a large variety of references in stock for delivery in a few days and we adapt to special requirements for any type of business and storage. From the lightest shelving to the most sophisticated automatic storages.

We always offer efficient storages by studying each case and adapting the best solution for it:

- Optimize the available space.
- Increase storage capacity.
- Make the square metre of storage more profitable.
- Provide a more logical order for easy location and greater protection against damages and losses.
- More security for staff and facilities.
- Generate higher productivity in operations and resources.
- Offer a better service to our customers.



## SOLUTIONS

Industrial racking/shelving to store all types of products. Light, medium and heavy loads, palletised loads, big loads...

Standard Pallet Racking, Drive-in Racking, Cantilever, Rack-clad storage systems and automatic systems, Long Span racking, Boltless shelving (Riveto), Multi-tier shelving, mezzanines, metallic containers. All of them formed a great range of storage solutions which, together with our experienced team, will solve your storage problems with quality, safety and lower cost.



## Technology

Our machinery at your service. We are equipped with the most flexible and advanced production systems for the design and manufacture of parts, components and competitive metal products.



## Lab Tests

We have a Testing Laboratory where the performance of all different components of each system is verified by testing loads, resistance, buckling ...

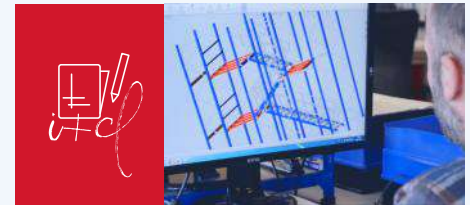

## Innovation

Innovate to improve, both in **new products** and in the optimization of existing products.

## Quality



Esnova sets as a priority the quality standards in each and every one of the processes it develops.

- Certificate in the quality management system (ISO 9001).
- Certificate in the environmental management system (ISO 14001).
- Certificate in the occupational health and safety management system (ISO 45001).
- UNE EN 1090 Certificate of CE Marking.
- Member of the European Federation of Maintenance FEM/AEM.



Management System  
 ISO 9001:2015  
 ISO 14001:2015  
 ISO 45001:2018  
 www.tuv.com  
 ID: 9105076955



# RACK CLAD BUILDINGS

## THE BEST SOLUTION FOR THE STORAGE IN HEIGHT (MORE THAN 40 M. HIGH)

The racking is its own building structure (self-supported).

Construction of conventional warehouse building is not required.

Makes the maximum use of available space.

Flexible and adaptable to your storage needs (loading units, dimensions, ...)

Automated systems with levels of productivity.





41.000 pallets



## TECHNOLOGICALLY ADVANCED SOLUTIONS

Rack clad buildings storage solutions are technologically advanced structures, that allow the storage of palletized goods in the height (up to +40 m.), and serve the dual function of storage equipment and building structure, on which cladding and roof are fixed.





77.000 pallets

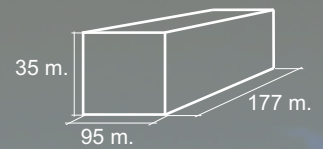

## VERSATILITY AND PRODUCTIVITY

Each rack clad warehouse is unique, because each project has its own requirements and each customer requires a solution adapted to its needs. Rack clad buildings provide a solution for the particular logistic problem posed, and can achieve a high grade of automation and high level of productivity, reducing the operating costs in the warehouses.



19.000 paletas

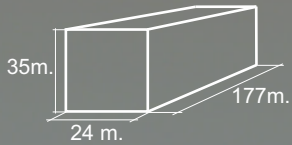

## PROFESSIONAL AND COMPREHENSIVE PROJECT MANAGEMENT

From the inception and the design of the most appropriate logistic solution, including the calculation applying valid norms and standards, the execution of tests when required, the manufacturing of the racking components that build up the storage system, up to the installation on site with supervision of own supervisors with extensive experience.

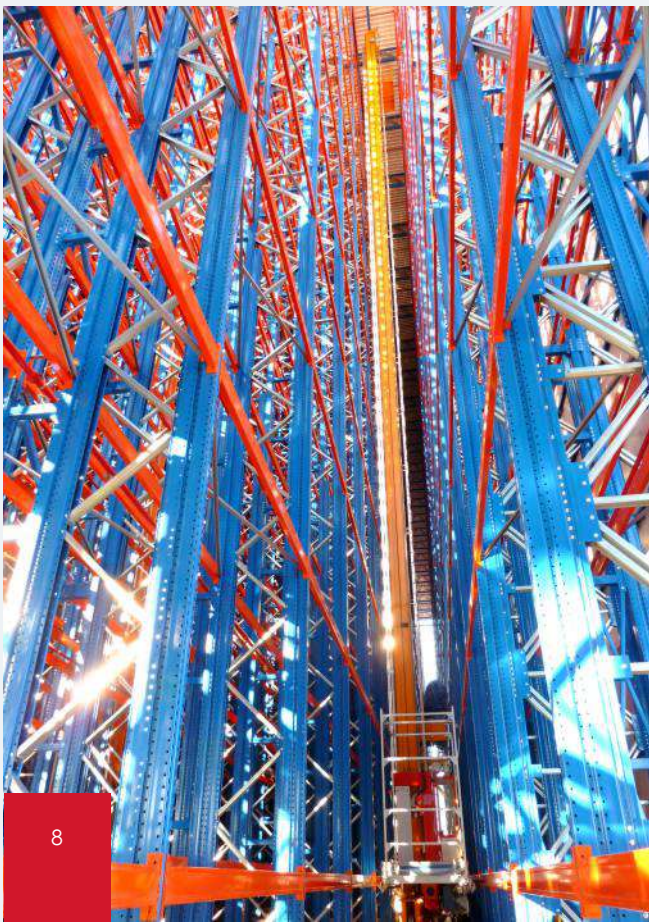





31.420 paletas

34 m.

56 m.

121 m.

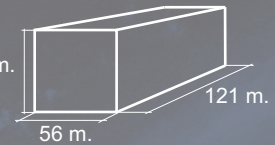

## DESIGN AND KNOW HOW

For the design of rack clad building storage solutions state of the art technic and norms are applied. 3D calculation and finite element procedures permit the optimization to support all loads like own weight, loading units, forces produced by stacker cranes, as well as wind, snow and seismic loads when required.

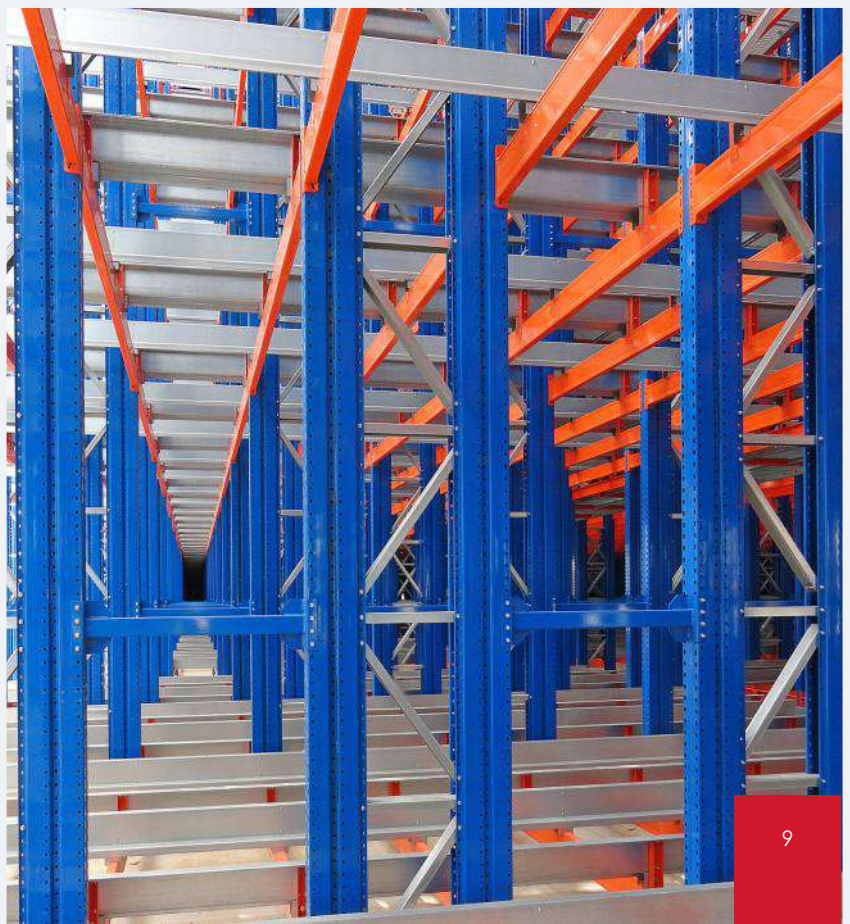

9.168 paletas  
 9.232 block pallets  
 8.000 cajas

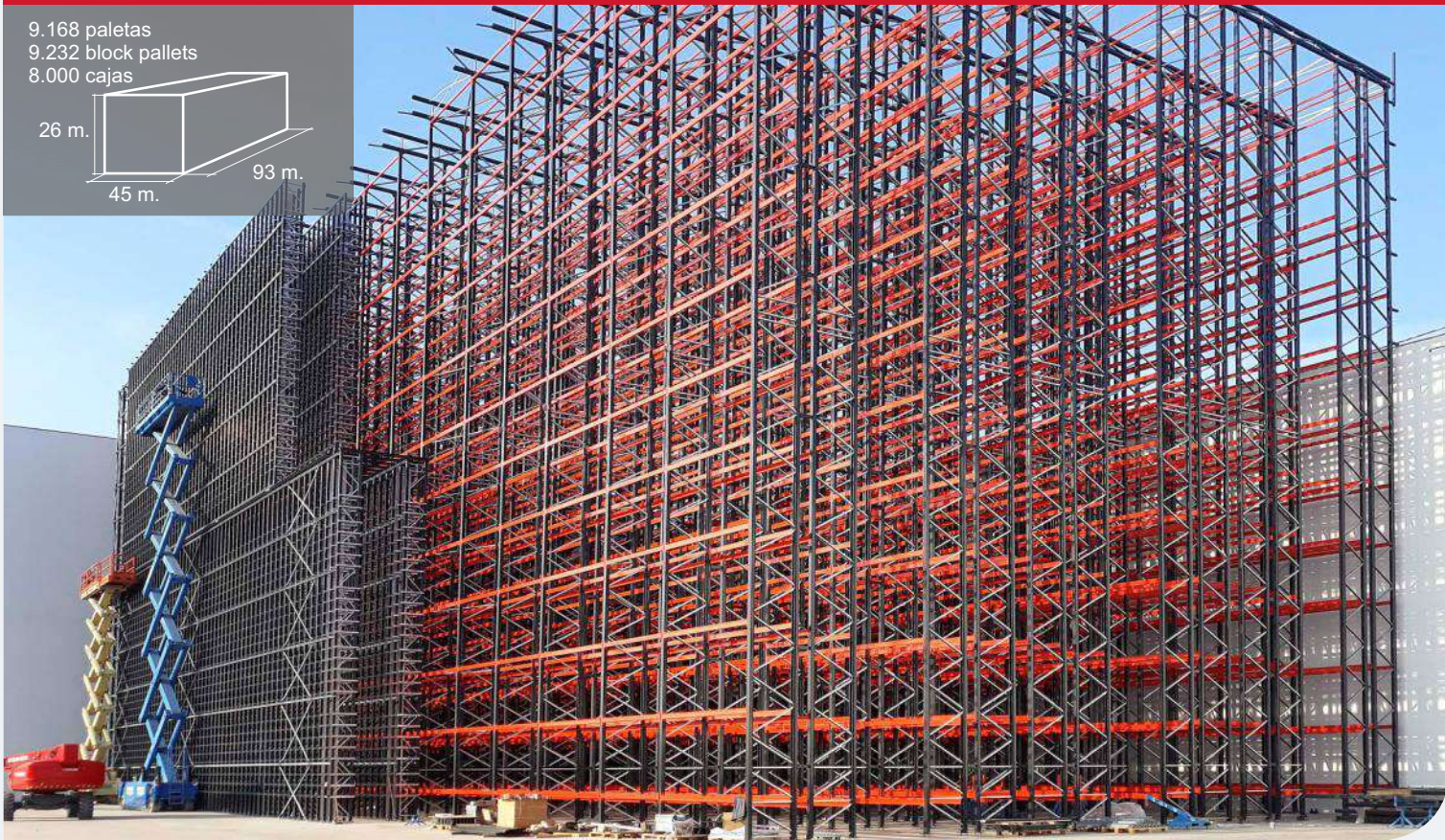
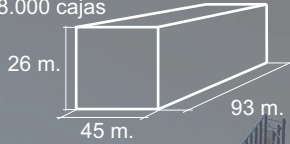

## SPECIFIC DEVELOPMENTS

Rack clad buildings for the storage of boxes permit to combine the storage of light duty boxes with an optimize space utilization both in height and on plant, with a higher process automation of order picking. Together with a high storage density, picking times and errors can be reduced.

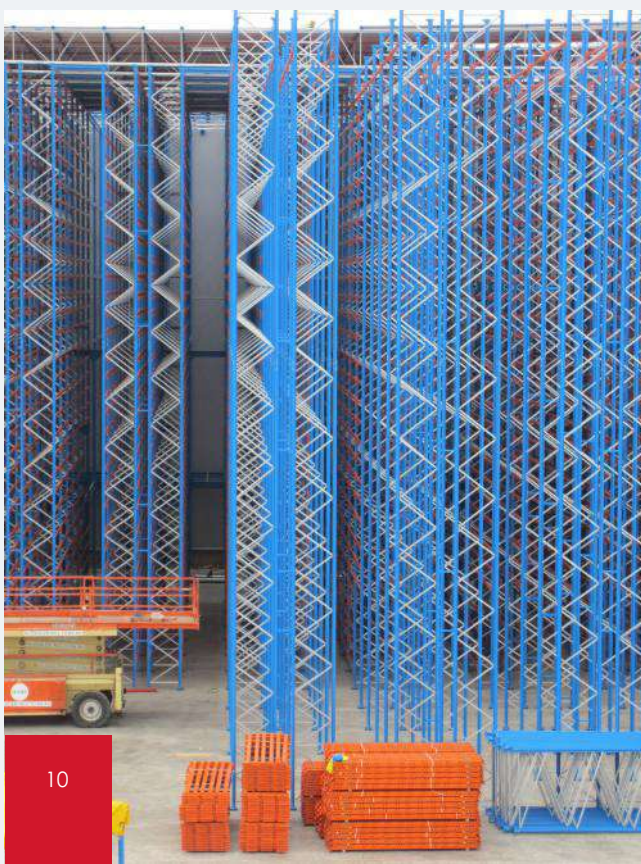

# RACK CLAD BUILDING MINILOAD FOR THE STORAGE OF BOXES

**Esnova**



## WITH ALL GUARANTEES

Rack clad buildings are big installations of permanent nature where the racking equipment also serves as fixing support for lateral cladding and roof. According to the european regulation 305/2011/UE (Construction Products Regulation or CPR), which is in force since July 1st of 2014, all rack clad buildings have to be certified with the so called CE marking.

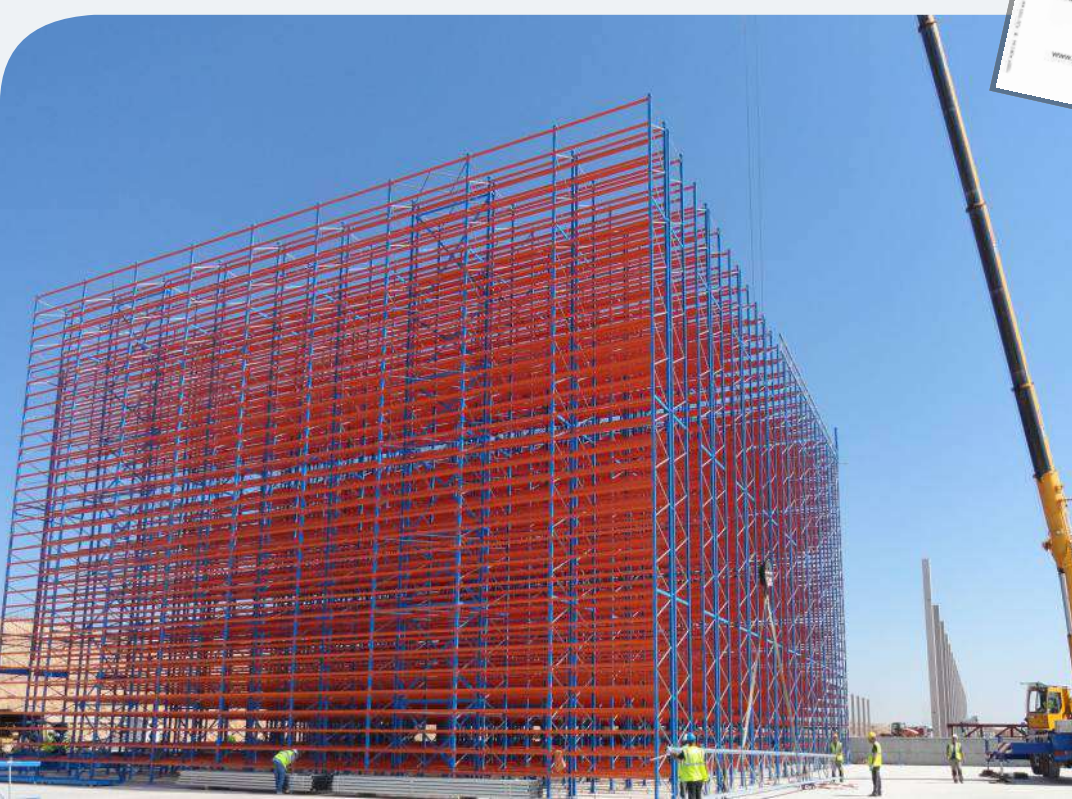

Esnova certifies all its rack clad warehouses with a CE marking certificate according to the norm EN 1090-1:2009 / AI 2011 "Execution of steel structures and aluminum structures. Requirements for conformity assessment of structural components".

# AUTOMATED WAREHOUSES

MANAGE YOUR WAREHOUSE ON AN AUTOMATED WAY AND OPTIMIZE THE STORAGE, THE PICKING PROCESSES AND THE SHIPPING OF YOUR GOODS.

Maximum stock control.

Speed up your picking processes.

Higher efficacy in the inbound and outbound of goods.

Save space, time and money.



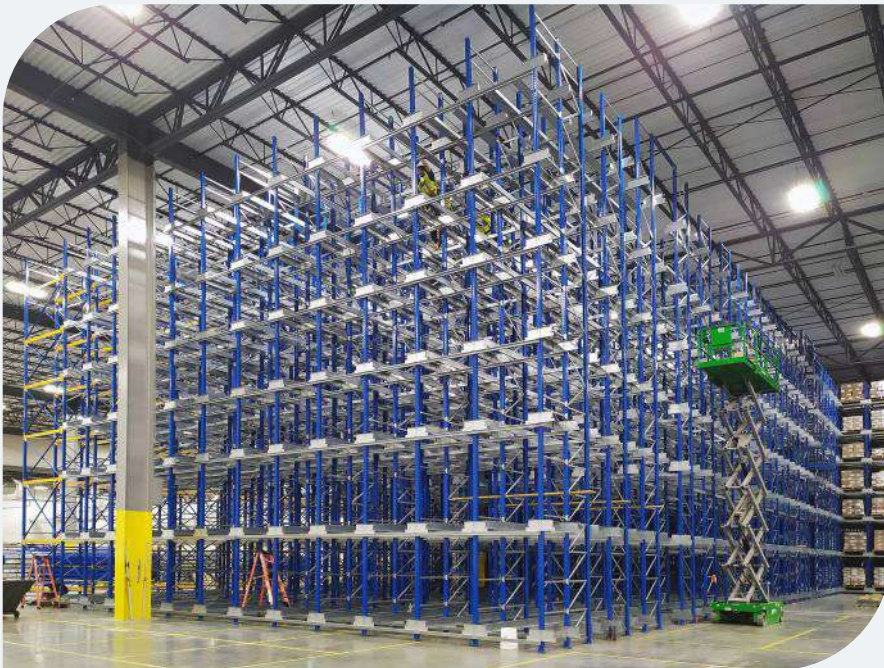
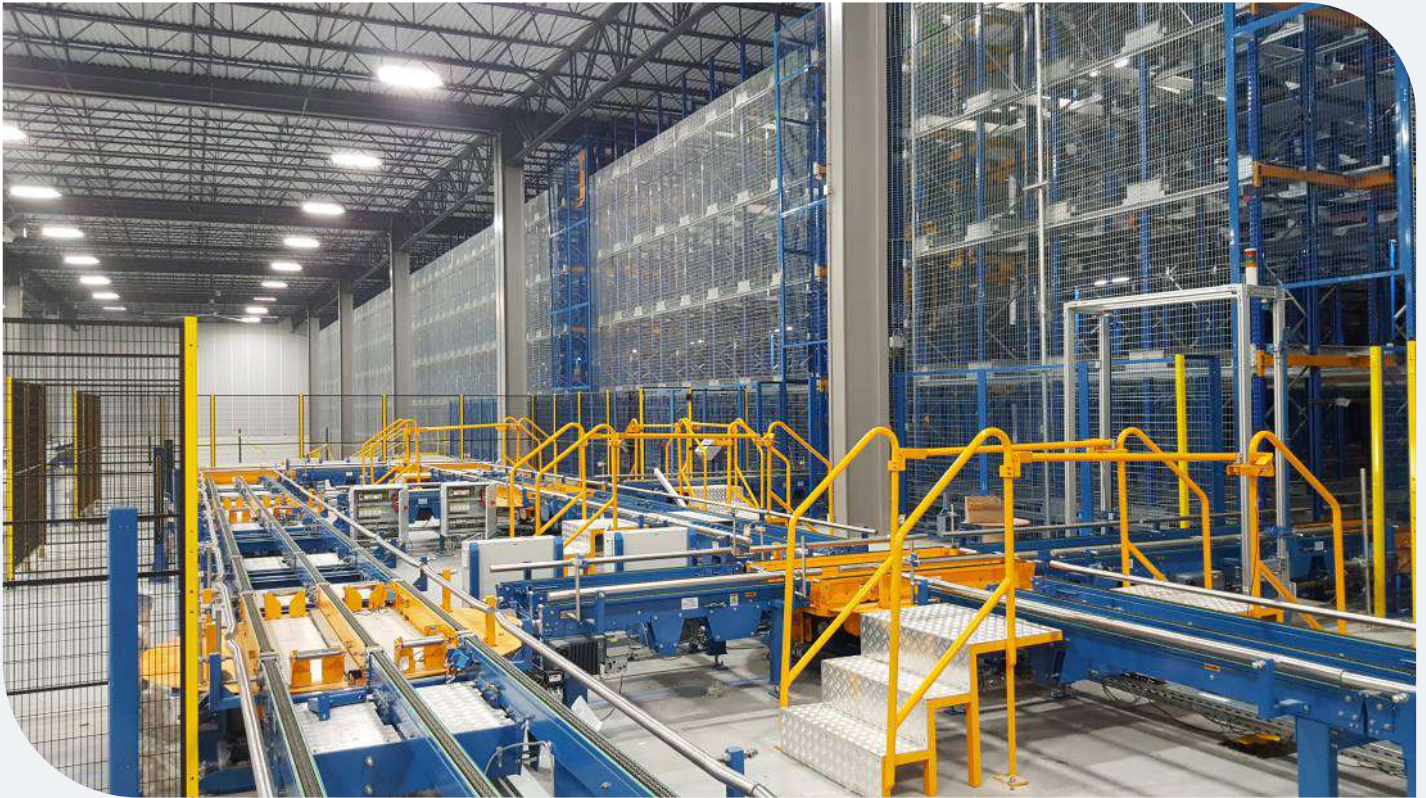

These are high-rise palletized load storage systems whose load units are handled by satellite shuttle cars.

This system makes it possible to automate the warehouse by using a reduced number of aisles and increasing storage density.



---

## PALLET RACKING OPERATED BY STACKER CRANES

Storage systems for palletized goods stored in the high and narrow aisles. The loading units are handled by automated stacker cranes. These storage solutions can be designed as single or double deep structures, and also as open face solutions for the storage of a single pallet per level and bay.



## TECHNOLOGY AT THE SERVICE OF THE STORAGE INDUSTRY

The automation of logistic processes and the storage through technologically advanced automated applications, requires the deployment of industrial racking systems adapted to the requirements and operative specifications of the project.

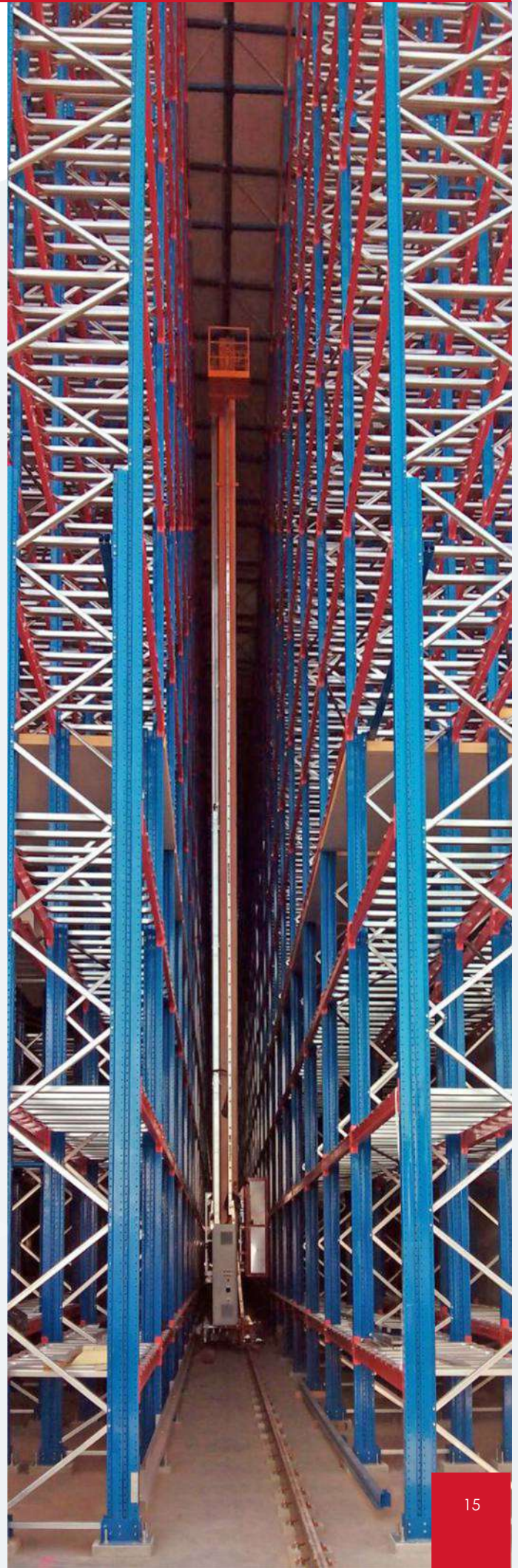
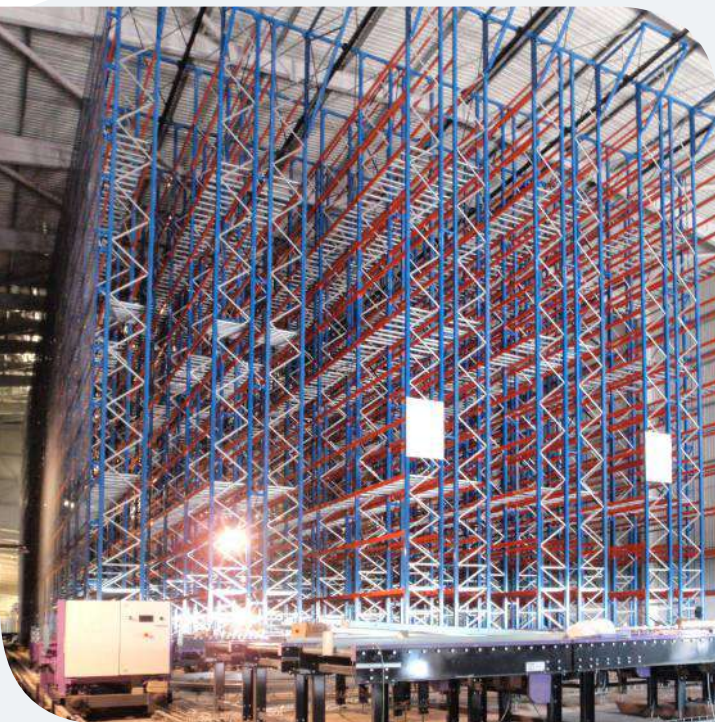

## PALLET RACKING FOR THE ACCUMULATIVE STORAGE THROUGH SHUTTLES

The loading units are stored in the depth. They can be handled through stacker cranes or also with elevators and transport shuttle.



## PRODUCTIVITY AND COST REDUCTION

The automation of the storage systems increases the productivity of your logistic activities.

A reduction of operating costs and damages, as well as an increase in safety can be achieved through higher levels of automation.







## MINILOAD

### APPROPRIATE FOR THE STORAGE OF LIGHT BOXES

Appropriate for the storage of light boxes.

Loading units are light boxes. Miniload systems can be operated with stacker cranes for one box per level (uniload), or for multiple boxes per level (multiload).

The storage solution can be designed for storage of boxes in depth operated by stacker cranes combined with shuttle cars. Very high projects can be projected as multilevel miniload solution with 2 stacker cranes in height.



## QUALITY ASSURANCE

Automated storage systems are very precise solutions that require high quality standards for the racking with very strict tolerances.

Esnova makes available to its customers proved quality procedures and a competent human team with extensive experience in the design and installation of racking systems.



# AUTOMATED SYSTEMS FOR HANGING GARMENTS

## TEXTILE INDUSTRY

Esnova has developed special solutions in the fashion industry for the storage of hanging garments. Hangers can be disposed on rods manipulated by stacker cranes that deposits and collects them from special supports installed on the racking. Special solution can be developed for the manipulation of hanging garments through aerial transport conveyors disposed on multitier mezzanines.

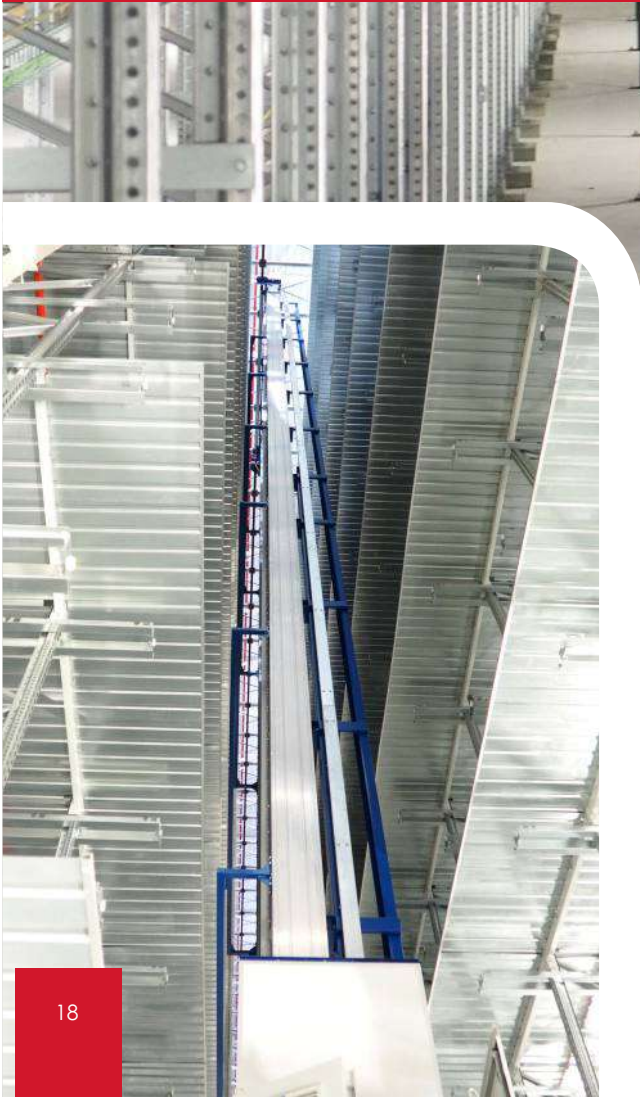

## COMPREHENSIVE PROJECT MANAGEMENT

From the inception and the design of the most appropriate logistic solution, including the calculation applying valid norms and standards, the execution of tests when required, the manufacturing of the racking components that build up the storage system, up to the installation on site from our own experienced supervisors.





The Strength of simplicity

WE DESIGN AND MANUFACTURE STORAGE SYSTEMS FROM THE MOST BASIC OPTION TO THE MORE SOPHISTICATED ONE.



PLEASE ASK FOR OUR CATALOGUES OR DOWNLOAD THEM FROM OUR WEBSITE

www.esnova.com



Management System  
ISO 9001:2015  
ISO 14001:2015  
ISO 45001:2018



www.tuv.com  
ID 9105076955

## ESNOVA SOFTWARE WHAREHOUSE MANAGEMENT SOFTWARE

### ¿HOW TO ORGANIZE A WHAREHOUSE?

This software specially designed to the warehouse management is the perfect IT tool to have a logistic control of your storage space.



MULTI-DEVICE SOFTWARE

#### ESNOVA RACKS, S.A.

C/ Ataúlfo Frieria "Tarfe", Nº 5 · Pol. Ind. Los Campones - Tremañes - 33211 · Gijón (Asturias - Spain)

+34 985 308 980

info@esnova.es